



**Supplies Not Included:** The following items are NOT supplied and will be needed to complete the installation: water supply line, water shut off valve (if replacing), sealant, 2 - closet bolts, wax ring, and toilet seat.

**Caution:** This toilet is made of fine china that is ruggedly constructed. Rough handling or dropped tools could chip or crack the product. Extra precaution should be taken to reduce the risk.

**Prior to Installation:** Turn off the toilet supply valve and flush the toilet. If replacing the supply valve, the main water supply will need to be shut off. Sponge out the remaining water from the bowl. Disconnect and remove the water supply line. Remove the mounting bolt nuts and washers, then lift the toilet from the flange. Plug the waste opening to prevent sewer gas from escaping. Clean the old wax from the flange and thoroughly clean the surrounding floor. A 4-inch drain with a slotted toilet flange will need to be installed prior to new toilet installation.

## Installing the Toilet Bowl and Tank

1

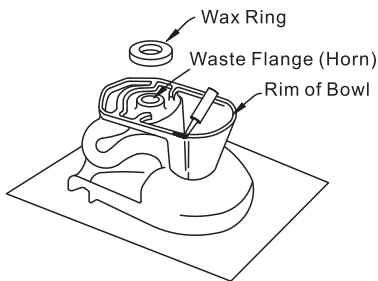

Insert the new toilet bolts in the slotted flange with the bolt heads down. Place the toilet bowl upside down on a soft material to prevent scratching. Place the wax ring evenly around the waste flange (horn), with tapered end of the ring facing the toilet. Apply a thin bead of sealant around the toilet base.

2



Unplug the floor waste hole opening. Gently place the bowl right side up, in position with the mounting bolts protruding through the holes in the toilet base. Press down with a slight rocking motion on the top center with your full weight. Verify the retainer washers "THIS SIDE UP" is facing up, then loosely install the retainer washers and nuts. Use a level to confirm the bowl is level, then tighten the nuts evenly and snugly. Smooth the bead of sealant around the base and remove excess sealant with a damp cloth. Cut the bolt height to size as needed and install the caps on the retaining washers. Pour water into the bowl to prevent sewer gas from escaping.

**IMPORTANT - DO NOT OVER TIGHTEN NUTS!** Over tightening the nuts can cause chips and cracks.

3

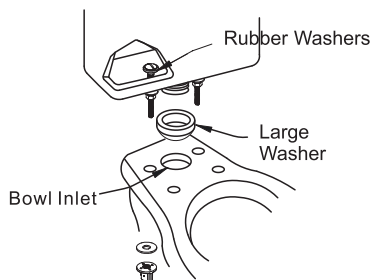

Carefully remove the tank and lid. Gently place the tank upside down on a soft material to prevent scratching. Please make sure the large washer (doughnut) is installed correctly. It should fit snugly over the plastic lock nut on the threaded tank outlet. Remove the plastic nut and metal washer. Place the tank on the toilet bowl with the large doughnut washer center on the bowl inlet. From underneath, add a metal washer and plastic nut to each bolt leaving loose for adjustments. Verify the tank is parallel to the wall and slightly tighten the plastic nuts alternating back and forth, until the tank is in contact with the bowl piers.

**IMPORTANT - DO NOT OVER TIGHTEN NUTS!** Over tightening the nuts can cause chips and cracks.

4

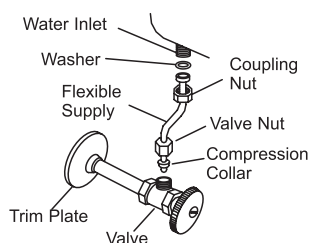

Connect the water supply line (not included) to the supply valve. Place the washer inside the coupling nut and screw onto the toilet water inlet. If necessary, slightly bend the supply line to reach the water inlet. Tighten all nuts securely.

5

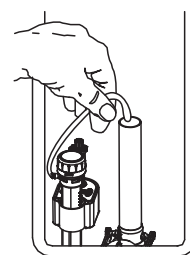

If the plastic tubing comes out of the overflow tube please connect the plastic tubing from the tip of the water inlet regulator into its holding ring inside the overflow tube. If necessary, excess may be trimmed to eliminate any leaks.

6

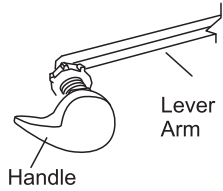

Remove the lever and nut from the parts bag. Insert the lever through the hole in the tank. Thread the nut onto the threaded shank. (Left handed levers will turn clockwise; Right handed levers turn counterclockwise.) Tighten the nut with a wrench until snug.

**NOTE:** Skip this step if the lever is already installed.

7

Turn the on the supply valve and check for leaks. Flush the toilet and let the toilet complete one cycle. Adjust the water level as needed to ensure it reaches the water level line marked inside the toilet. Raise water level: Turn the flow adjusting screw clockwise. Lower water level: Turn the flow adjusting screw counterclockwise.

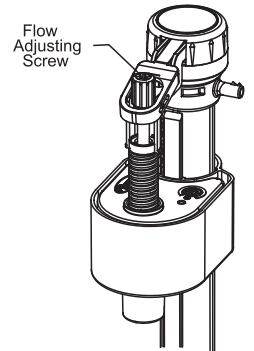

8

Place the cover on the tank. Install the toilet seat in accordance with the manufacturers instructions.

## 9 Care and Cleaning of Vitreous China

Your new toilet is made of stain, acid and abrasion resistant vitreous china. But, like all fine finishes the china requires reasonable care. For day-to-day cleaning, wash with warm water, a soft cloth, and a mild detergent . On stubborn stains, use one of the powdered detergents , on a damp sponge or scouring pad of nylon, saran, or poly-ethylene. Never use abrasive scouring powders, cleansers, or pads as they tend to create microgrooves that dull the finish and allow dirt to work into the surface. Use of tank cleaning products containing calcium hypochlorite (chlorine) or any other reactive chemical shall constitute improper maintenance and may void the warranty.

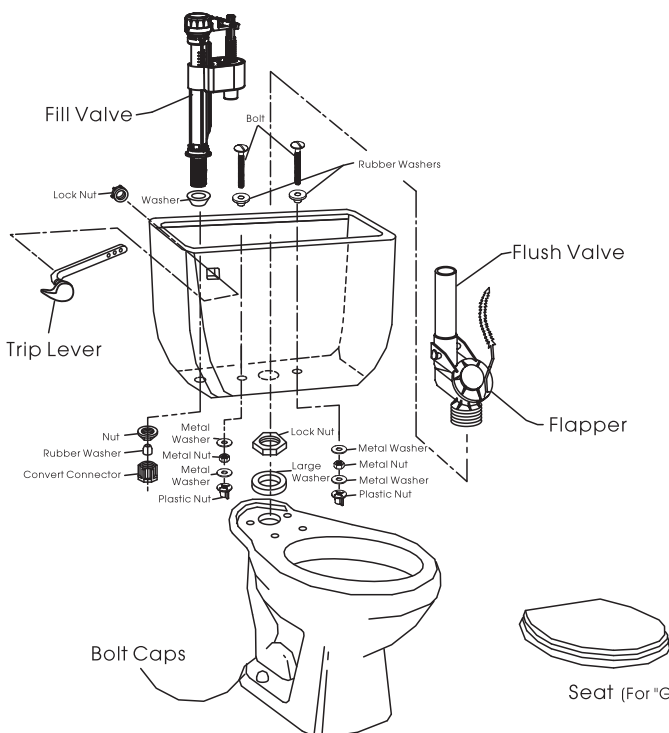

## REPLACEMENT PARTS

Please keep this manual for future reference. Retain product invoice . Record the Model Number of the toilet in this booklet. This will assist when ordering replacement parts.



## LIMITED WARRANTY

### Vitreous China

Canton Bathware Vitreous China is warranted to the original consumer purchaser to be free from defects in material and workmanship for as long as the original consumer purchaser owns the home in which the toilet was first installed or for 5 years from the date of purchase.

### Mechanical Parts

Mechanical parts of the Canton Bathware toilet are warranted to the original consumer purchaser to be free from defects in material and workmanship for 1 year from the date of purchase.

**Toilet Care Tip:** Over time, hard water deposits may clog toilet rim holes and trapways. To clean, purchase a commercial cleaner that's recommended for the removal of hard water deposits. Follow all instructions on the package.

Canton Bathware will replace, free of charge, during the applicable warranty period, any part or finish that proves defective in material and/or workmanship under normal installation, use and service. Canton Bathware recommends using a professional plumber for all installation and repair. Replacement parts may be obtained by emailing the address below, calling the number below or by writing to:

Compass Manufacturing International  
Canton Bathware Product Service  
6702 Enterprise Drive  
Louisville, KY 40214  
800.626.3525  
www.cmiproduct.com  
warranty@cmiproduct.com  
Canton Bathware is a division of Compass Manufacturing International

## Vitreous China Product Care

### Regular Maintenance:

Remove stains using a cleaning product that contains mild abrasives; rinse and towel dry. Strong abrasive cleaners will scratch and dull the surface. Use toilet bowl cleaners on the inside of the bowl only. Do not use in-tank toilet cleaners as they can damage the flush valve or other working parts and may void the warranty. Wipe any splashes of cleaner solutions from plastic or plated surfaces immediately.

### Products to Consider

Comet Bathroom Cleanser  
Formula 409 Antibacterial All Purpose

Windex Original  
Soft Scrub Original